

Courses on the Creek (Adding three Acres into the Calculation for Jutts on Creek.)

North -- 5 1/2 ff.
 N 30 W -- 15
 N 7 E -- 37
 S 84 E -- 47 1/2
 N 15 W -- 16
 N 17 E -- 36 1/2
 N 20 W -- 32
 N 57 W -- 16
 N 24 W -- 15 1/2
 N 55 W -- 12 1/2
 S 37 W -- 9
 S 70 W -- 14
 N 85 W -- 7
 N 79 W -- 20
 S 32 W -- 12 1/2
 S 16 E -- 5
 S 69 W -- 9
 S 43 W -- 11
 N 68 W -- 9
 West -- 22
 S 71 W 2 1/2
 354 1/4 ff.

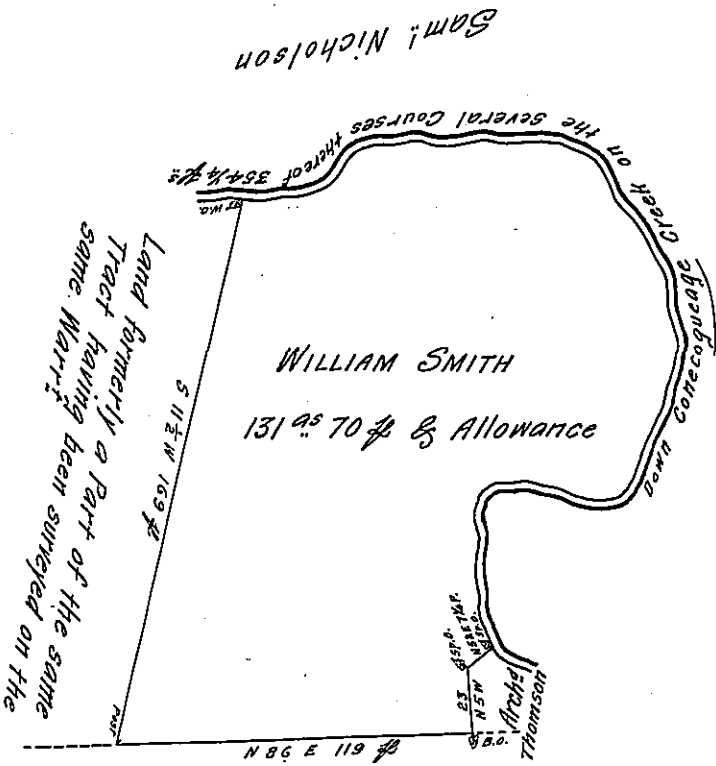

Albert Torrence

A Draft of a Tract or Parcel of Land situate formerly in Letterkenny Township in the County of Cumberland, but now in Green Township in the County of Franklin Containing One Hundred and thirty one Acres and seventy Perches and the Allowance of Six ff Cent for Roads &c being Part of a Tract formerly survey'd in pursuance of a Warrant granted to William Smith bearing Date the 12th Day of August 1765. Resurveyed and laid off the 31st Day of May 1792.

Matt^r Henderson D.S.

N.B. Samuel Nicholson claims five Acres included within the present survey along the Creek on the South Side, and opposite his Land on the North Side thereof, including a Swamp, by Virtue of his Warrant dated the 29th Day of December 1791, alleging the same was not included in the original Survey on William Smith's Warrant, to Daniel Brodhead Esq^r } Surveyor General } M. H.

IN TESTIMONY that the above is a copy of the original remaining on file in the Department of Internal Affairs of Pennsylvania, made conformably to an Act of Assembly approved the 16th day of February, 1833, I have hereunto set my Hand and caused the Seal of said Department to be affixed at Harrisburg, this twenty-ninth day of October 1907.

Henry Houck
 Secretary of Internal Affairs.